

# Standard EI Size List

Unit: mm    Version: A

Specification	Dimension for each part														
	GOODS	A	B	C	D	E	F	G	H	I	J	K	N	Φ1	Φ2
EI-28	28.0	25.0	8.0	4.0	6.0	17.0	21.0	4.0							
EI-30	30.0	25.0	10.0	5.0	5.0	15.0	20.0	5.0							
EI-35	35.0	29.5	9.60	5.0	7.7	19.5	24.5	5.0							
EI-41	41.0	33.0	13.0	6.0	8.0	21.0	27.0	6.0							
EI-41-2H	41.0	33.0	13.0	6.0	8.0	21.0	27.0	6.0				27.0		3.0	
EI-48	48.0	40.0	16.0	8.0	8.0	24.0	32.0	8.0							
EI-48B	48.0	40.0	16.0	8.0	8.0	24.0	32.0	8.0	40.0	32.0	4.0		3.5		
EI-48-2H	48.0	40.0	16.0	8.0	8.0	24.0	32.0	8.0				32.0		3.5	
EI-57	57.0	47.5	19.0	9.5	9.5	28.5	38.0	9.5							
EI-57B	57.0	47.5	19.0	9.5	9.5	28.5	38.0	9.5	48.0	38.0	4.75		4.0		
EI-57-2H	57.0	47.5	19.0	9.5	9.5	28.5	38.0	9.5				38.0		4.0	
EI-60	60.0	50.0	20.0	10.0	10.0	30.0	40.0	10.0							
EI-66	66.0	55.0	22.0	11.0	11.0	33.0	44.0	11.0							
EI-66B	66.0	55.0	22.0	11.0	11.0	33.0	44.0	11.0	56.0	44.0	5.5		4.5		
EI-74	74.0	65.0	23.0	11.5	14.0	37.0	51.0	14.0							
EI-75	75.0	62.5	25.0	12.5	12.5	37.5	50.0	12.5							
EI-76.2	76.2	63.5	25.4	12.7	12.7	38.1	50.8	12.7							
EI-76.2B	76.2	63.5	25.4	12.7	12.7	38.1	50.8	12.7	64.0	50.8	6.35		5.0		
EI-78B	78.0	65.0	26.0	13.0	13.0	39.0	52.0	13.0	65.0	52.0	6.5		5.0		
EI-85.8	85.8	71.5	28.6	14.3	14.3	42.9	57.2	14.3							
EI-85.8B	85.8	71.5	28.6	14.3	14.3	42.9	57.2	14.3	71.0	57.2	7.15		5.0		
EI-96B	96.0	80.0	32.0	16.0	16.0	48.0	64.0	16.0	79.0	64.0	8.0		6.0		
EI-105B	105.0	87.5	35.0	17.5	17.5	52.5	70.0	17.5	87.0	70.0	8.75		6.0		
EI-114B	114.0	95.0	38.0	19.0	19.0	57.0	76.0	19.0	95.0	76.0	9.5		7.0		
EI-120B	120.0	100.0	40.0	20.0	20.0	60.0	80.0	20.0	100.0	80.0	10.0		7.0		

Specification	Dimension for each part													
	A	B	C	D	E	F	G	H	I	J	K	N	Φ1	Φ2
GOODS														
EI -132B	132	110.0	44.0	22.0	22.0	66.0	88.0	22.0	110.0	88.0	11.0		7.0	
EI -133.2B	133.2	111.0	44.4	22.2	22.2	66.6	88.8	22.2	111.0	88.8	11.1		7.0	
EI -150B	150.0	125.0	50.0	25.0	25.0	75.0	100.0	25.0	125.0	100.0	12.5		8.0	
EI -152.4B	152.4	127.0	50.8	25.4	25.4	76.2	101.6	25.4	127.0	101.6	12.7		8.0	
EI -162B	162.0	135.0	54.0	27.0	27.0	81.0	108.0	27.0	135.0	108.0	13.5		8.0	
EI -171B	171.0	142.5	57.0	28.5	28.5	85.5	114.0	28.5	142.5	114.0	14.25		9.0	
EI -180B	180.0	150.0	60.0	30.0	30.0	90.0	120.0	30.0	150.0	120.0	15.0		10.0	
EI -192B	192.0	160.0	64.0	32.0	32.0	96.0	128.0	32.0	160.0	128.0	16.0		10.0	
EI -210B	210.0	175.0	70.0	35.0	35.0	105.0	140.0	35.0	175.0	140.0	17.5		10.0	
EI -240B	240.0	200.0	80.0	40.0	40.0	120.0	160.0	40.0	200.0	160.0	20.0		10.0	
EI -270B	270.0	225.0	90.0	45.0	45.0	135.0	180.0	45.0	225.0	180.0	22.5		12.0	
EI -300B	300.0	250.0	100.0	50.0	50.0	150.0	200.0	50.0	250.0	200.0	25.0		12.0	

Maker: Huangjing 2012.01.01

Check: Xiahaiping

Approval: Liubin

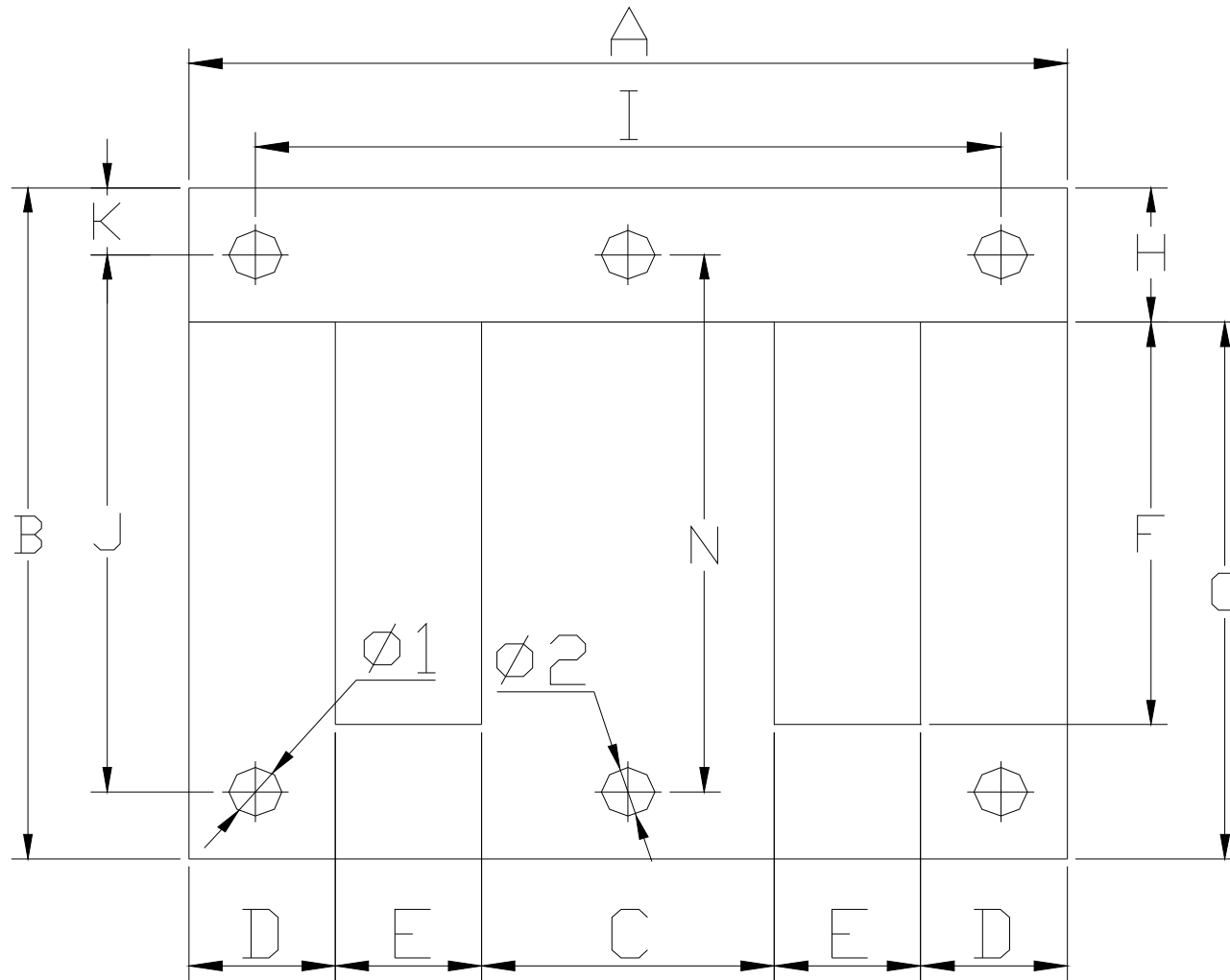

EI lamination Drawing